

Kit 1325

BMW 5-Series, 4-dr Sedan, 04-09

BMW 5-Series, 5-dr Touring, 04-09 (without railing)

BMW 5-Series, 5-dr Wagon, *04-10 (without railing)

*North America

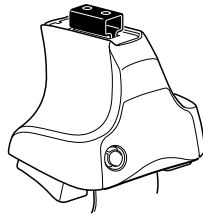

754 Rapid System
480R Rapid Traverse (North America)

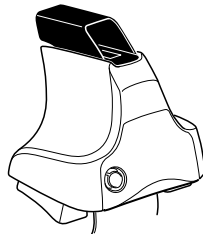
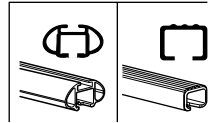

480 Traverse (North America)

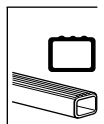

754 Rapid System
480R Rapid Traverse (North America)

480 Traverse (North America)

1

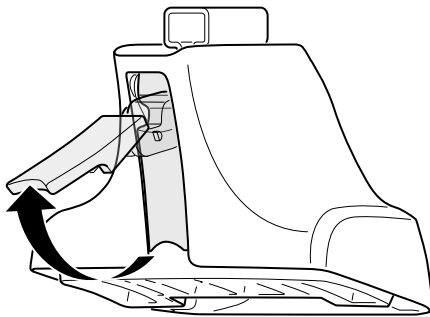

2



754 Rapid System
480R Rapid Traverse
(North America)

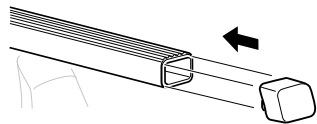
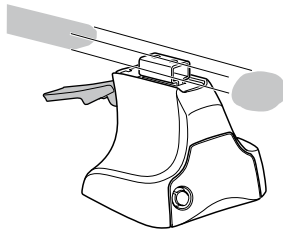

x4

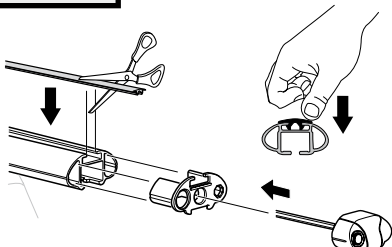

x4

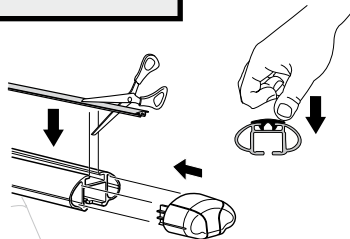
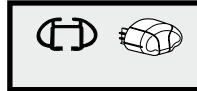

x4



480 Traverse
(North America)

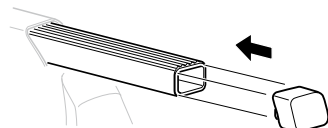
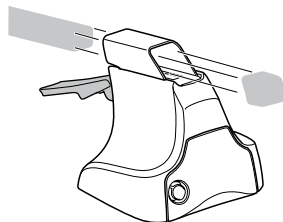

x4

3

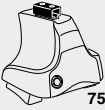

754 Rapid System

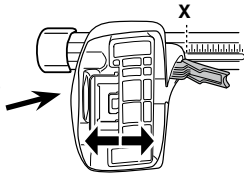

	X
BMW 5-Series, 4-dr Sedan, 04-09	36,5
BMW 5-Series, 5-dr Touring, 04-09 (without railing)	36,5
BMW 5-Series, 5-dr Wagon, *04-10 (without railing)	36,5

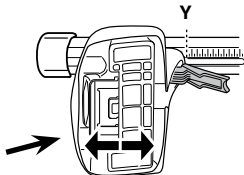

	Y
BMW 5-Series, 4-dr Sedan, 04-09	36
BMW 5-Series, 5-dr Touring, 04-09 (without railing)	34
BMW 5-Series, 5-dr Wagon, *04-10 (without railing)	34

3



480R Rapid Traverse



480 Traverse

(North America)

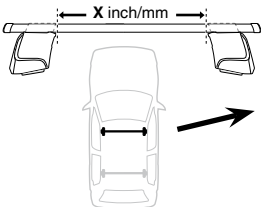

	X inch	X mm
BMW 5-Series, 4-dr Sedan, 04-09	40 "	1016 mm
BMW 5-Series, 5-dr Touring, 04-09 (without railing)	40 "	1016 mm
BMW 5-Series, 5-dr Wagon, *04-10 (without railing)	40 "	1016 mm

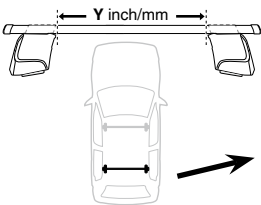

	Y inch	Y mm
BMW 5-Series, 4-dr Sedan, 04-09	39 3/4 "	1011 mm
BMW 5-Series, 5-dr Touring, 04-09 (without railing)	39 "	991 mm
BMW 5-Series, 5-dr Wagon, *04-10 (without railing)	39 "	991 mm

4

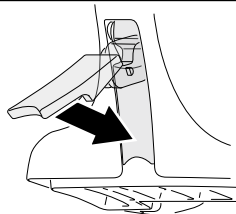

5

BMW 5-Series, 4-dr Sedan, 04-09

BMW 5-Series, 5-dr Touring, 04-09 (without railing)

BMW 5-Series, 5-dr Wagon, *04-10 (without railing)

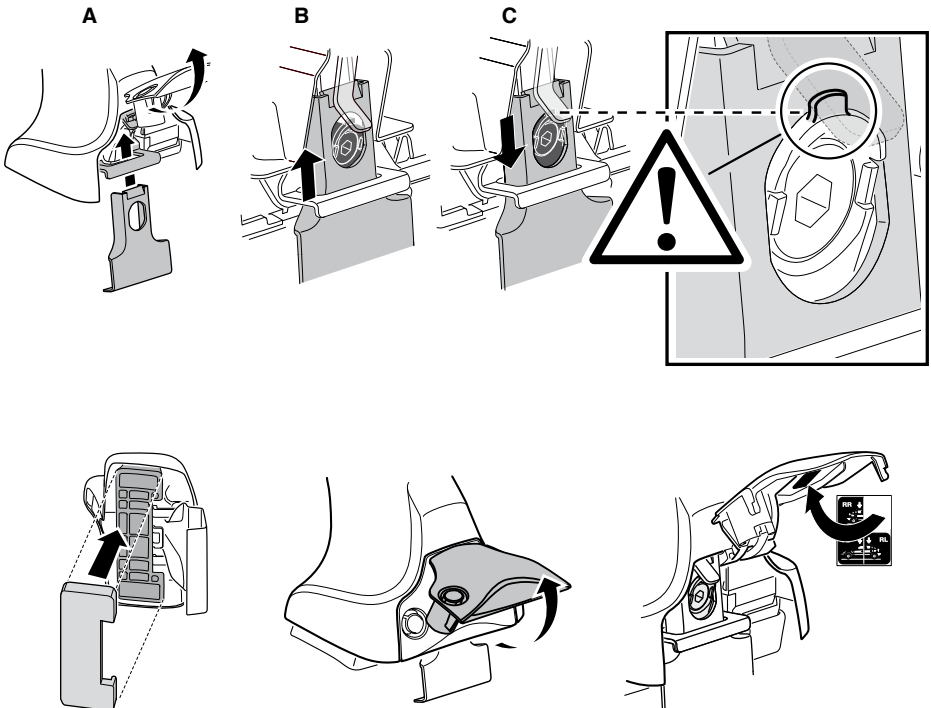
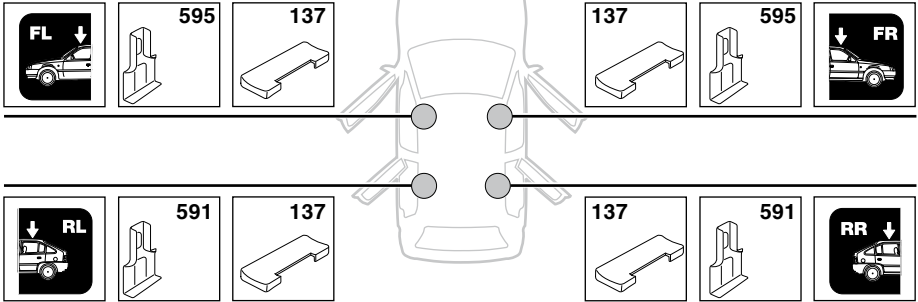

6

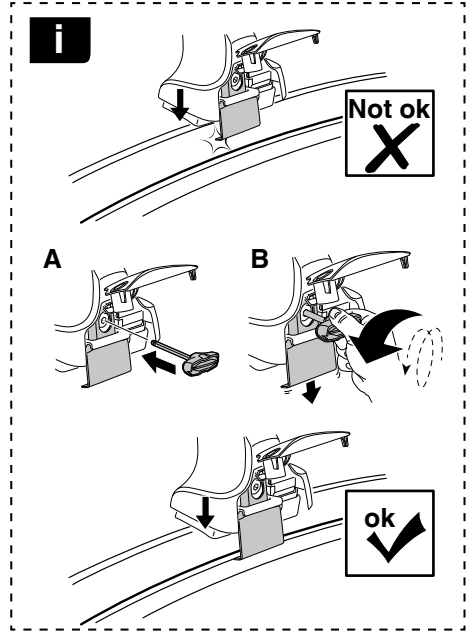
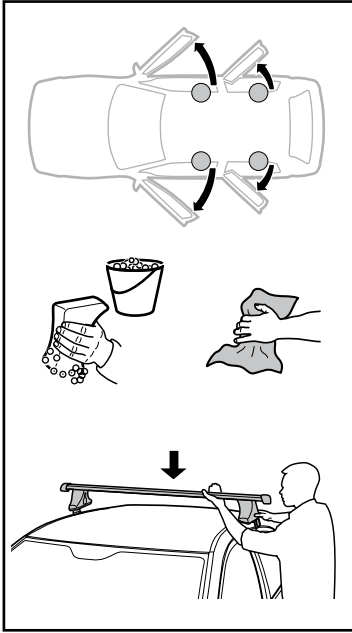

	X mm	Y mm	X inch	Y inch
BMW 5-Series, 4-dr Sedan, 04-09	270 mm	750 mm	10 ⁵ / ₈ "	29 ¹ / ₂ "
BMW 5-Series, 5-dr Touring, 04-09 (without railing)	270 mm	700 mm	10 ⁵ / ₈ "	27 ¹ / ₂ "
BMW 5-Series, 5-dr Wagon, *04-10 (without railing)	270 mm	700 mm	10 ⁵ / ₈ "	27 ¹ / ₂ "

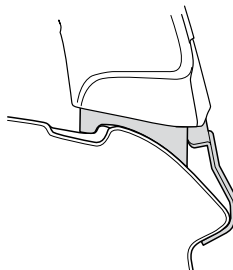
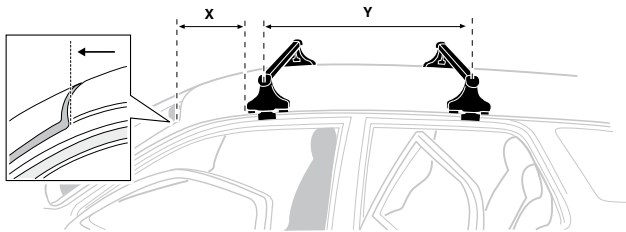

7

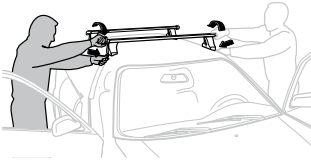

GB/US	Tighten alternately
D	Die Schrauben abwechselnd anziehen
F	Serrer alternativement chaque côté
NL	Afwisselend aan de linker- en de rechterkant aandraaien
I	Alternare il serraggio delle viti
E	Apretar alternativamente
PT	Aperte alternadamente
S	Dra åt växelvis
FIN	Kierrä vuorotellen
EST	Pinguldage vaheldumisi
LAT	Pielvecliet pamišus
LIT	Užsukinėkite pakaitomis
PL	Śruby dokręcaj naprzemiennie
RU	Затягивайте попеременно

CZ	Pokręťta bagażnika dokręcaj naprzemiennie.
SK	Doťahujte striedavo
SLO	Privijajte izmenično.
HR	Naizmjenično zategnite
HU	Egy mástól függetlenül szorítandó
GR	Σφιγγετέ εναλλάξ
TR	Dönüşümlü sıkın

中文 交替拧紧

한국어 번갈아 가며 조이십시오.

日本語 交互に締め付けてください。

ไทย ชั้้นในแบบสลับ

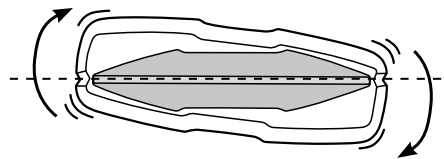
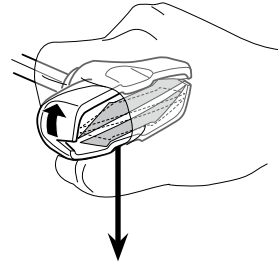
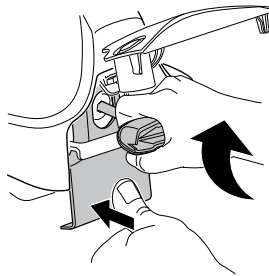
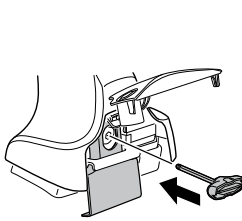

≈ 3 Nm

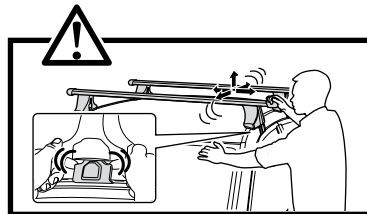
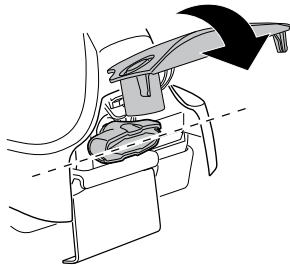

8



x1
17 mm

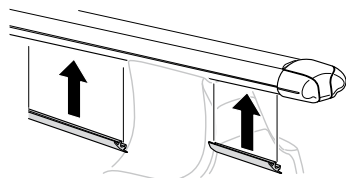

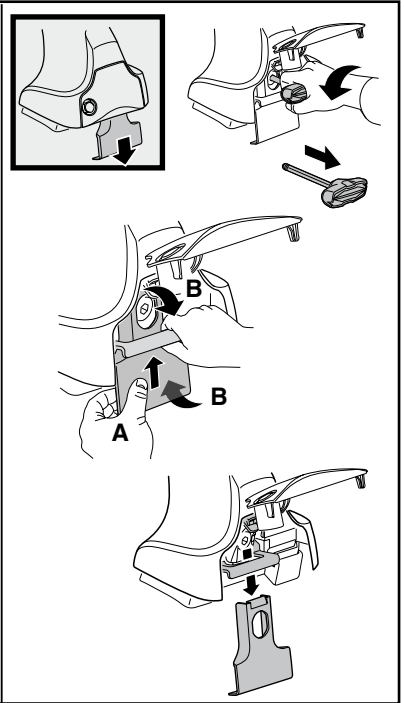
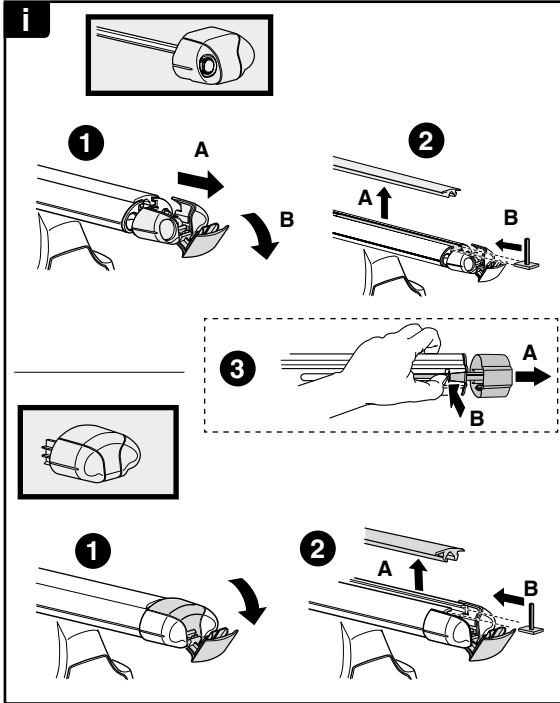

THULE
SWEDEN
**ONE
KEY
SYSTEM**

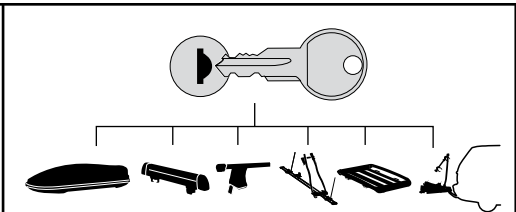

		(x4)
		(x6)
		(x8)
NA		(x10)
EUR		(x12)
ASIA		



WW ▶ Thule Sweden AB, Box 69, 330 33 Hillerstorp, SWEDEN
NA ▶ Thule Inc., 42 Silvermine Road, Seymour, Connecticut 06483, USA

info@thule.com
customer.service@thule.com

www.thule.com